

City of Pleasant Ridge

Members of the Recreation Commission and Residents: This shall serve as your official notification of the Regular Recreation Commission Meeting to be held on Wednesday, July 13, 2016, 7:00 P.M., at the Pleasant Ridge Community Center, 4 Ridge Road, Pleasant Ridge, Michigan 48069. The following items are on the agenda for your consideration:

REGULAR RECREATION COMMISSION MEETING

1. Meeting Called to Order
2. Roll Call
3. Consideration of the following minutes:
 - a. Regular Recreation Commission Meeting held Wednesday, June 29, 2016.
4. PUBLIC COMMENTS- items not on the agenda.
5. Consideration of the recommended Gainsboro 5-12 play structure design from the sub-committee.
6. Adjournment.

In the spirit of compliance with the Americans with Disabilities Act, individuals with a disability should feel free to contact the City at least seventy-two (72) hours in advance of the meeting, if requesting accommodations.

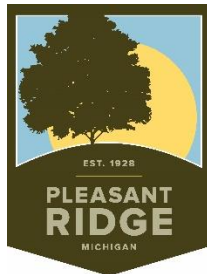

**RECREATION COMMISSION
MEETING MINUTES
June 29, 2016**

1. Meeting was called to order at 7:05

Roll Call: Christopher Budnik, Christine Matyas, Richard Cook, Jean Russell, Jacqueline Scully, Sue Terpack, Jason Krzysiak, Scott Pietrzak, Shawnie Stamper

Absent: Catherine Russell, Ester Weiner, Amanda Wahl

2. **Public Comments not on Agenda:** None

3. **Consideration of rescheduling the July 27, 2016 regular Recreation Commission meeting to July 13, 2016 at 7:00p.m.**

Motion: Russell Second: Terpack
Yeas: 6 Nays: 0

4. **Consideration of the report of the project sub-committees.**

- A. **Art Fair-** reminders and save the date sent out. 32 Artists last year.
- B. **Health, Wellness and Play-**good turnout, hot day, missed obstacle course. Ice cream social will be July 20th at the pool.
- C. **Community Pool** – 35 guest passes 1,132 homes. 452 on the deck is the limit. Revisit the possibility of changing the guest pass limit. Snack bar will reopen next week.

5. **Other Business:**

- Summer Camp going well. Swim team numbers are strong. Senior trips full.
- Rick questioned the pricing structure for Community Garden for next year. Scott agreed to meet on pricing and discuss raised beds. Rick knows master carpenters and experienced gardeners in the neighborhood. Rick would like to have a communication go out late September on pricing and expectations. Scott mentioned that he would like to add a security deposit on the community garden.

6. **Adjournment:** Motion: Terpack Second: Cook
Yeas: 6 Nays: 0

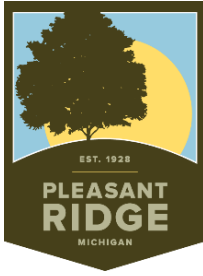

City of Pleasant Ridge

Scott Pietrzak, Assistant City Manager

From: Scott Pietrzak, Assistant City Manager
To: Members of the Recreation Commission
Date: July 12, 2016
Re: 5-12 year old Gainsboro play structure

After much research, park visits & public involvement the sub-committee has decided on a recommendation for a new 5-12 play structure for Gainsboro. The recommendation is for the design we have showed the group at previous meetings with a couple possible changes (size limitations). The recommendation is highlighted below and with the attached pictures.

- Landscape Structures EVOS System
- Component pieces that include
 - 7 Panel Mobius Climber
 - Proposed Global Motion (size) or Topsy Turny
 - Boogie Board
 - We-Saw
 - Swings

The recommended surface will be a hybrid of PIP (poured in place) surface and engineered wood fiber. The sub-committee feels this will give the play area maximum usage for all populations & special needs.

Therefore, the recommendation is to approve the EVOS design and corresponding components, with the Global Motion & Topsy Turny to be interchangeable based on space limitations. The surface will be a hybrid of PIP & engineered wood fiber.

Gainsboro Park 5-12

May 10, 2016 91572-1-3-1

Proposed new Global Motion

(if it fits)

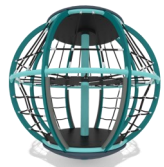

**Better playgrounds.
Better world.®**

playlsi.com



Proudly presented by:

Lance Shipman



*NOTE: PLEASE VERIFY ALL DIMENSIONS OF PLAY AREA, SIZE, ORIENTATION, AND LOCATIONS OF ALL EXISTING UTILITIES, EQUIPMENT, AND SITE FURNISHINGS PRIOR TO ORDERING. SLIDES SHOULD NOT FACE THE HOT AFTERNOON SUN.

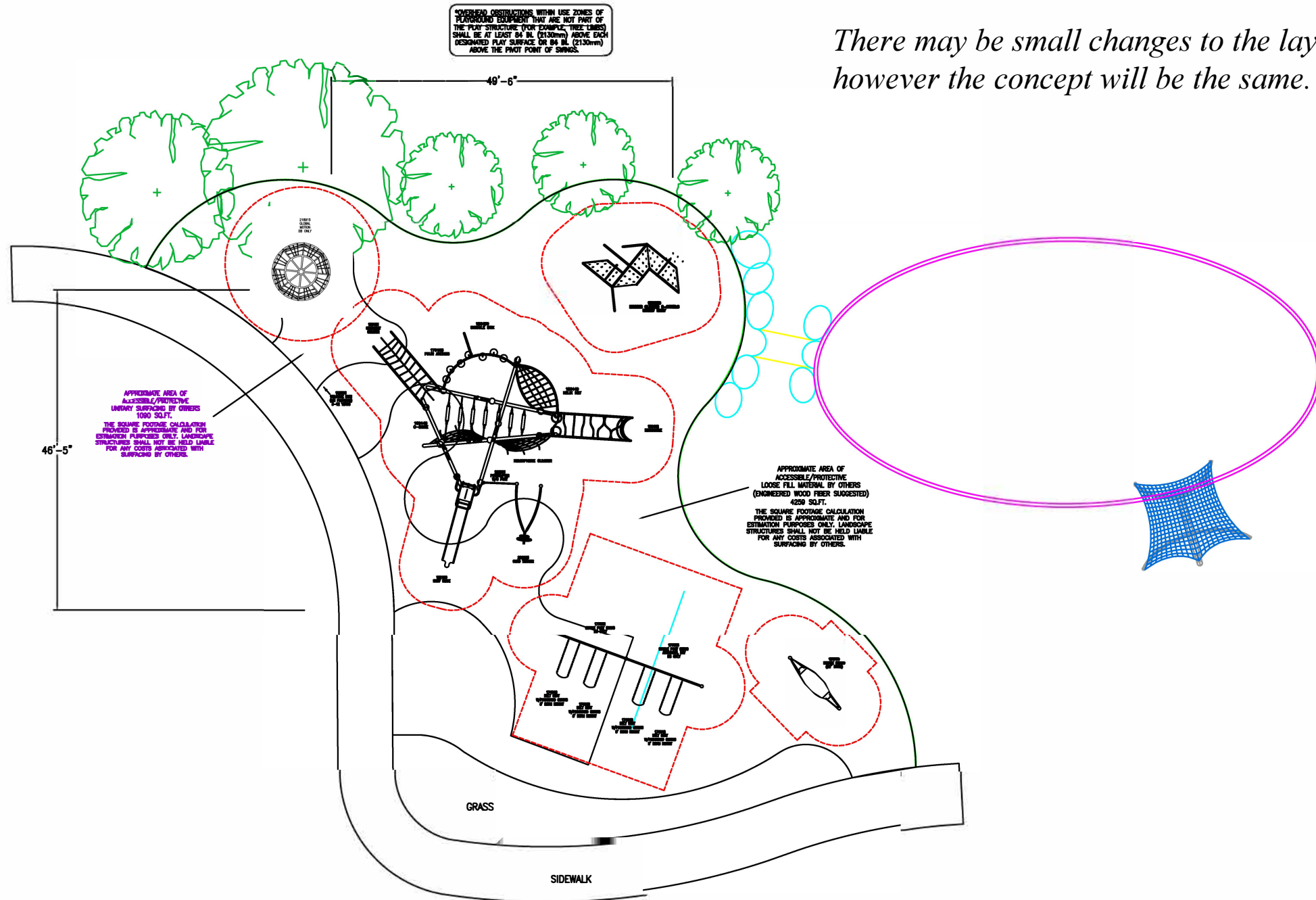

There may be small changes to the layout, however the concept will be the same.

landscape structures



The play components identified on this plan are IPEMA certified. (Unless model number is preceded with *) The use and layout of these components conform to the requirements of ASTM F1487. To verify product certification, visit www.ipema.org

THIS PLAY AREA & PLAY EQUIPMENT IS DESIGNED FOR AGES 5-12 YEARS UNLESS OTHERWISE NOTED ON PLAN.

IT IS THE MANUFACTURERS OPINION THAT THIS PLAY AREA DOES CONFORM TO THE A.D.A. ACCESSIBILITY STANDARDS, ASSUMING AN ACCESSIBLE PROTECTIVE SURFACING IS PROVIDED, AS INDICATED, OR WITHIN THE ENTIRE USE ZONE.

THIS CONCEPTUAL PLAN WAS BASED ON INFORMATION AVAILABLE TO US. PRIOR TO CONSTRUCTION, DETAILED SITE INFORMATION INCLUDING SITE DIMENSIONS, TOPOGRAPHY, EXISTING UTILITIES, SOIL CONDITIONS, AND DRAINAGE SOLUTIONS SHOULD BE OBTAINED, EVALUATED, & UTILIZED IN THE FINAL DESIGN. PLEASE VERIFY ALL DIMENSIONS OF PLAY AREA, SIZE, ORIENTATION, AND LOCATION OF ALL EXISTING UTILITIES, EQUIPMENT, AND SITE FURNISHINGS PRIOR TO ORDERING. SLIDES SHOULD NOT FACE THE HOT AFTERNOON SUN.

CHOOSE A PROTECTIVE SURFACING MATERIAL THAT HAS A CRITICAL HEIGHT VALUE TO MEET THE MAXIMUM FALL HEIGHT FOR THE EQUIPMENT (REF. ASTM F1487 STANDARD CONSUMER SAFETY PERFORMANCE SPECIFICATION FOR PLAYGROUND EQUIPMENT FOR PUBLIC USE, SECTION 8 CURRENT REVISION). THE SUBSURFACE MUST BE WELL DRAINED. IF THE SOIL DOES NOT DRAIN NATURALLY IT MUST BE TILED OR SLOPED 1/8" TO 1/4" PER FOOT TO A STORM SEWER OR A "FRENCH DRAIN".

ACCESSIBLE/PROTECTIVE SURFACING TO BE A COMBINATION OF UNITARY AND LOOSE FILL MATERIALS.

DESIGNED BY:

SG
 COPYRIGHT: 2/15/16
 LANDSCAPE STRUCTURES, INC.
 801 7th STREET SOUTH - P.O. BOX 198
 DELANO, MINNESOTA 55328
 PH: 1-800-328-0035 FAX: 1-763-972-8081

Date	Previous Drawing #	Initials

TOTAL ELEVATED PLAY COMPONENTS	0		
TOTAL ELEVATED COMPONENTS ACCESSIBLE BY RAMP	0	REQUIRED	0
TOTAL ELEVATED COMPONENTS ACCESSIBLE BY TRANSFER	0	REQUIRED	0
TOTAL ACCESSIBLE GROUND LEVEL COMPONENTS SHOWN	16	REQUIRED	0
TOTAL DIFFERENT TYPES OF GROUND LEVEL COMPONENTS	13	REQUIRED	13



Gainsboro Park 5-12

Penchura, LLC

Lance Shipman

SYSTEM TYPE:
Evos

DRAWING #:
91572-1-1

