

## City of Pleasant Ridge

Members of the Recreation Commission and Residents: This shall serve as your official notification of the Regular Recreation Commission Meeting to be held on Wednesday, March 30, 2016, 7:00 P.M., at the Pleasant Ridge Community Center, 4 Ridge Road, Pleasant Ridge, Michigan 48069. The following items are on the agenda for your consideration:

### **REGULAR RECREATION COMMISSION MEETING**

1. Meeting Called to Order
2. Roll Call
3. Consideration of the following minutes:
  - a. Regular Recreation Commission Meeting held Wednesday, January 27, 2016.
4. PUBLIC COMMENTS- items not on the agenda.
5. Consideration of the appointment of a Secretary for the Pleasant Ridge Recreation Commission (tabled in January).
6. Consideration of the of the update on the Gainsboro Park Renovations.
7. Consideration of the report of the project sub-committees:
  - a. Art Fair
  - b. Health, Wellness & Play
  - c. Community Pool
8. Other Business
9. Adjournment.

**In the spirit of compliance with the Americans with Disabilities Act, individuals with a disability should feel free to contact the City at least seventy-two (72) hours in advance of the meeting, if requesting accommodations.**

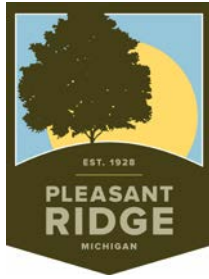

**RECREATION COMMISSION  
MEETING MINUTES  
January 27, 2016**

1. Meeting was called to order at 7:05

**Roll Call:** Richard Cook, Cathrine Russell, Jean Russell, Jacqueline Scully, Sue Terpack, Amanda Wahl, Jason Krzysiak, Scott Pietrzak, Shawnie Stamper

**Absent:** Christopher Budnik, Christine Matyas

2. **Consideration of the minutes of the Recreation Commission Meeting held, Wednesday, October 28, 2015.** Accepted with corrections

Motion:	Wahl	Second:	J. Russell
	Yeas: 6	Nays: 0	

3. **Public Comments not on Agenda:** None

4. **Consideration of the update on the Gainsboro Park Renovations**

Pietrzak reported the 60% drawings for the Gainsboro Park Renovations should be approved by the City Commission and sent back to LivingLabs to prepare for bid specs in March. The anticipated construction start date is set for the end of May.

5. **Consideration of the appointment of a Chairperson for the Pleasant Ridge Recreation Commission.** Christopher Budnik's name was presented for Chairperson.

Motion:	Terpack,	Second:	Wahl
	Yeas: 6	Nays: 0	

J. Scully was thanked for the year of service as Chairperson. K. Kelly was also thanked for his years of service.

6. **Consideration of the appointment of a Secretary for the Pleasant Ridge Recreation Commission:**

Tabled until next meeting.

7. **Consideration of the report of the project sub-committees.**

a: **Art Fair:** None

b: **Community Garden:** No garden in 2016. Further plans will be made once there is progress about the new location.

- c:     **Health, Wellness and Play:** There will need to be a new schedule for summer events usually held in Gainsboro Park.
8. **Other Business:** The city has applied for grants of \$25,000, with a matching amount from the city, for beautification of the parks. Also for a MI DNR grant, with a 30 to 40% match, for the pavilion in Gainsboro Park.
9. **Adjournment:**       Motion:                   Terpack       Second:               J. Russell





Gainsboro Park Pavilion  
Pedestrian Perspective



Architecture    Landscape Architecture  
Interior Design    Urban Design

Artist's Representation - subject  
to change without notification

2-23-16





Gainsboro Park Pavilion  
Bird's Eye Perspective



Architecture Landscape Architecture  
Interior Design Urban Design

Artist's Representation - subject  
to change without notification

2-23-16



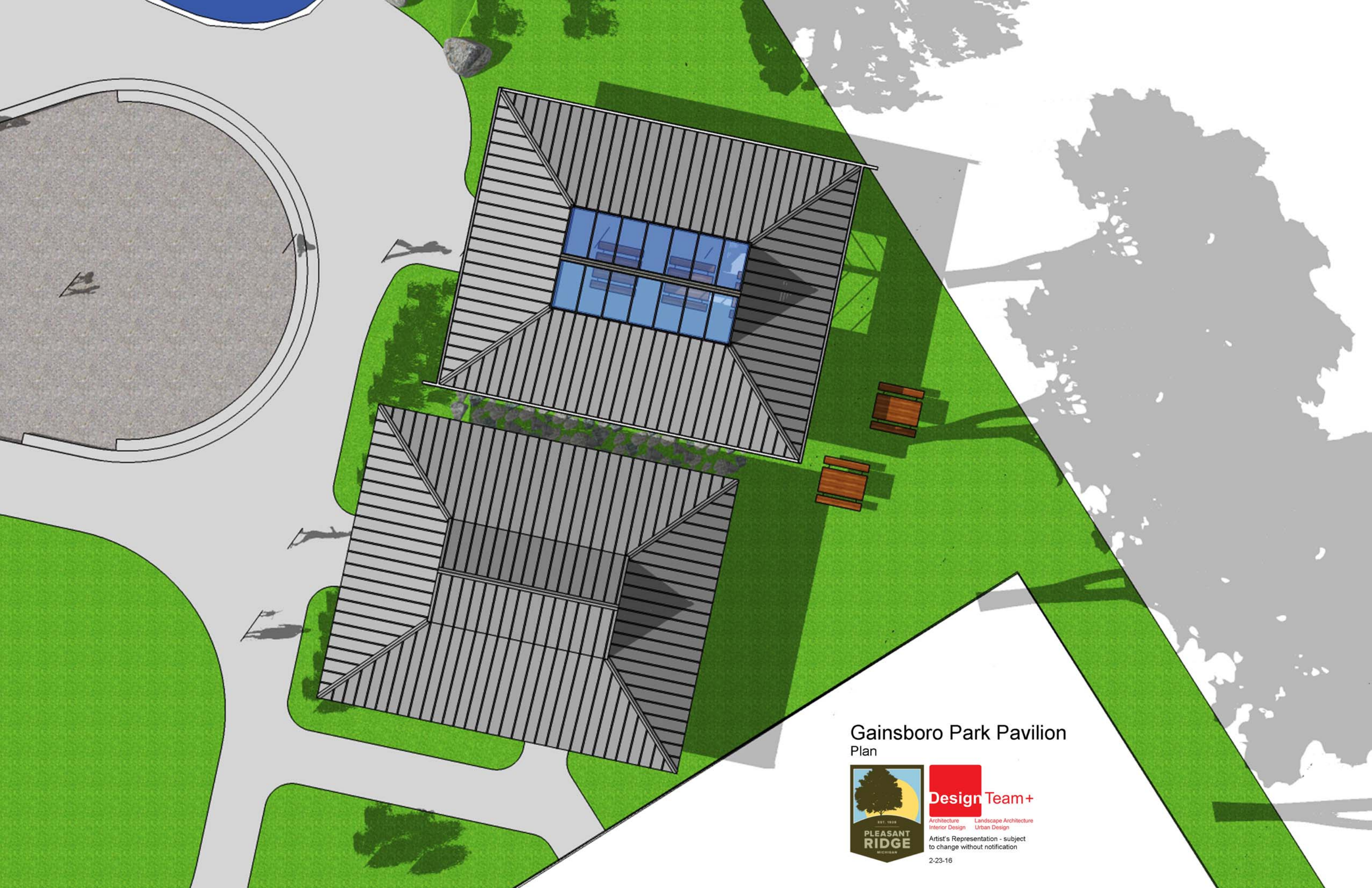

## Gainsboro Park Pavilion Plan



Architecture Landscape Architecture  
Interior Design Urban Design

Artist's Representation - subject  
to change without notification

2-23-16





Gainsboro Park Pavilion  
Color Alternative





\*NOTE: PLEASE VERIFY ALL DIMENSIONS OF PLAY AREA, SIZE, ORIENTATION, AND LOCATIONS OF ALL EXISTING UTILITIES, EQUIPMENT, AND SITE FURNISHINGS PRIOR TO ORDERING. SLIDES SHOULD NOT FACE THE HOT AFTERNOON SUN.

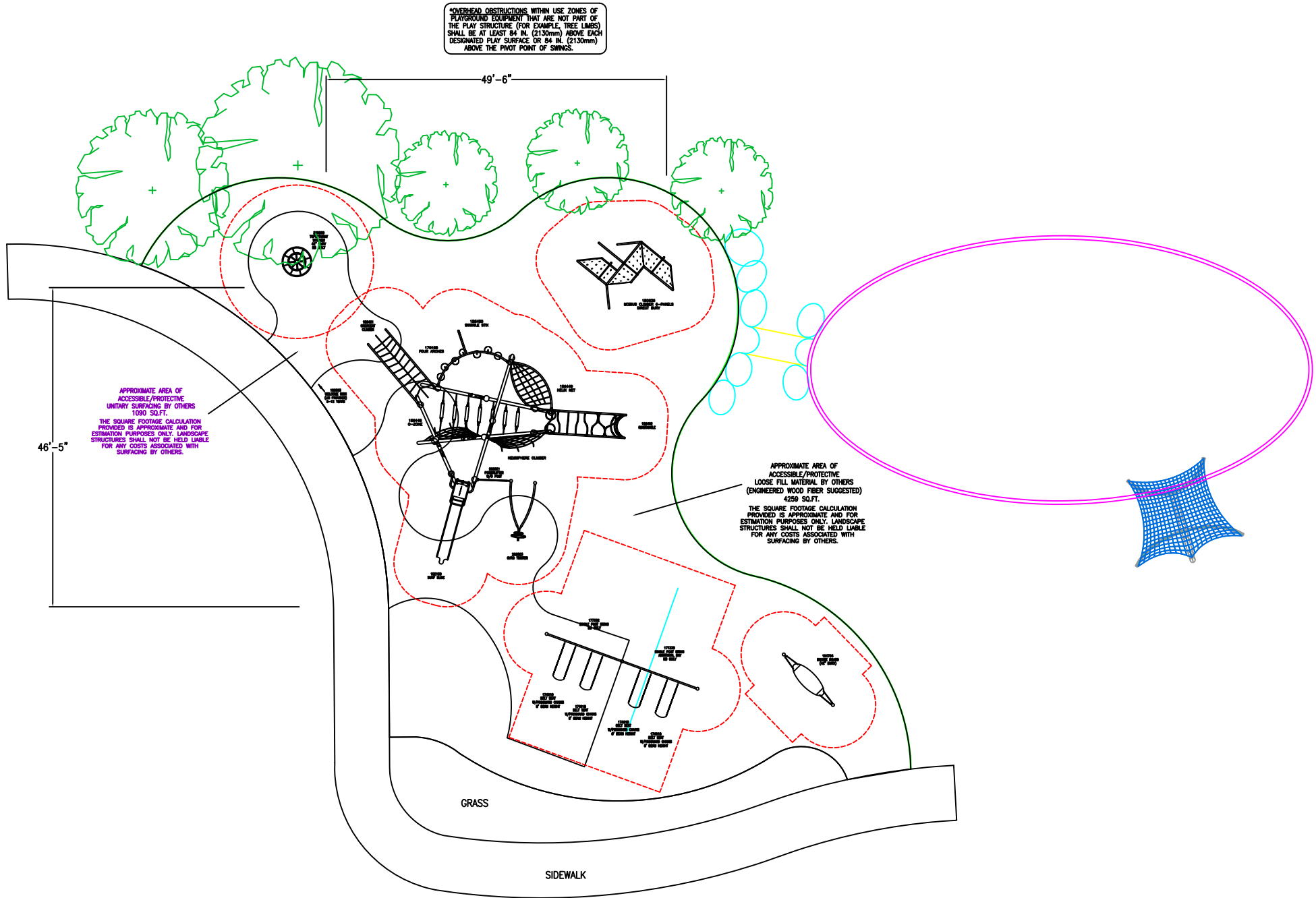

TOTAL ELEVATED PLAY COMPONENTS	0		
TOTAL ELEVATED COMPONENTS ACCESSIBLE BY RAMP	0	REQUIRED	0
TOTAL ELEVATED COMPONENTS ACCESSIBLE BY TRANSFER	0	REQUIRED	0
TOTAL ACCESSIBLE GROUND LEVEL COMPONENTS SHOWN	16	REQUIRED	0
TOTAL DIFFERENT TYPES OF GROUND LEVEL COMPONENTS	13	REQUIRED	13



Gainsboro Park 5-12

Penchura, LLC  
Lance Shipman

SYSTEM TYPE:  
Evos

DRAWING #:  
91572-1-1



landscape  
structures



The play components identified on this plan are IPEMA certified. (Unless model number is preceded with \*) The use and layout of these components conform to the requirements of ASTM F1487. To verify product certification, visit [www.ipema.org](http://www.ipema.org)

THIS PLAY AREA & PLAY EQUIPMENT IS DESIGNED FOR AGES 5-12 YEARS UNLESS OTHERWISE NOTED ON PLAN.

IT IS THE MANUFACTURERS OPINION THAT THIS PLAY AREA DOES CONFORM TO THE A.D.A. ACCESSIBILITY STANDARDS, ASSUMING AN ACCESSIBLE PROTECTIVE SURFACING IS PROVIDED, AS INDICATED, OR WITHIN THE ENTIRE USE ZONE.

THIS CONCEPTUAL PLAN WAS BASED ON INFORMATION AVAILABLE TO US. PRIOR TO CONSTRUCTION, DETAILED SITE INFORMATION INCLUDING SITE DIMENSIONS, TOPOGRAPHY, EXISTING UTILITIES, SOIL CONDITIONS, AND DRAINAGE SOLUTIONS SHOULD BE OBTAINED, EVALUATED, & UTILIZED IN THE FINAL DESIGN. PLEASE VERIFY ALL DIMENSIONS OF PLAY AREA, SIZE, ORIENTATION, AND LOCATION OF ALL EXISTING UTILITIES, EQUIPMENT, AND SITE FURNISHINGS PRIOR TO ORDERING. SLIDES SHOULD NOT FACE THE HOT AFTERNOON SUN.

CHOOSE A PROTECTIVE SURFACING MATERIAL THAT HAS A CRITICAL HEIGHT VALUE TO MEET THE MAXIMUM FALL HEIGHT FOR THE EQUIPMENT (REF. ASTM F1487 STANDARD CONSUMER SAFETY PERFORMANCE SPECIFICATION FOR PLAYGROUND EQUIPMENT FOR PUBLIC USE, SECTION 8 CURRENT REVISION). THE SUBSURFACE MUST BE WELL DRAINED. IF THE SOIL DOES NOT DRAIN NATURALLY IT MUST BE TILED OR SLOPED 1/8" TO 1/4" PER FOOT TO A STORM SEWER OR A "FRENCH DRAIN".

ACCESSIBLE/PROTECTIVE SURFACING TO BE A COMBINATION OF UNITARY AND LOOSE FILL MATERIALS.

DESIGNED BY:  
SG

COPYRIGHT: 2/15/16  
LANDSCAPE STRUCTURES, INC.  
601 7th STREET SOUTH - P.O. BOX 198  
DELANO, MINNESOTA 55328  
PH: 1-800-328-0035 FAX: 1-763-972-6091

Date	Previous Drawing #	Initials
------	--------------------	----------



# Gainsboro Park 5-12

February 16, 2016 91572-1-1R



landscape  
structures®



**Better playgrounds.  
Better world.®**

playlsi.com



Proudly presented by:  
Lance Shipman



Penchura<sup>LLC</sup>



# Gainsboro Park 5-12

February 16, 2016 91572-1-1

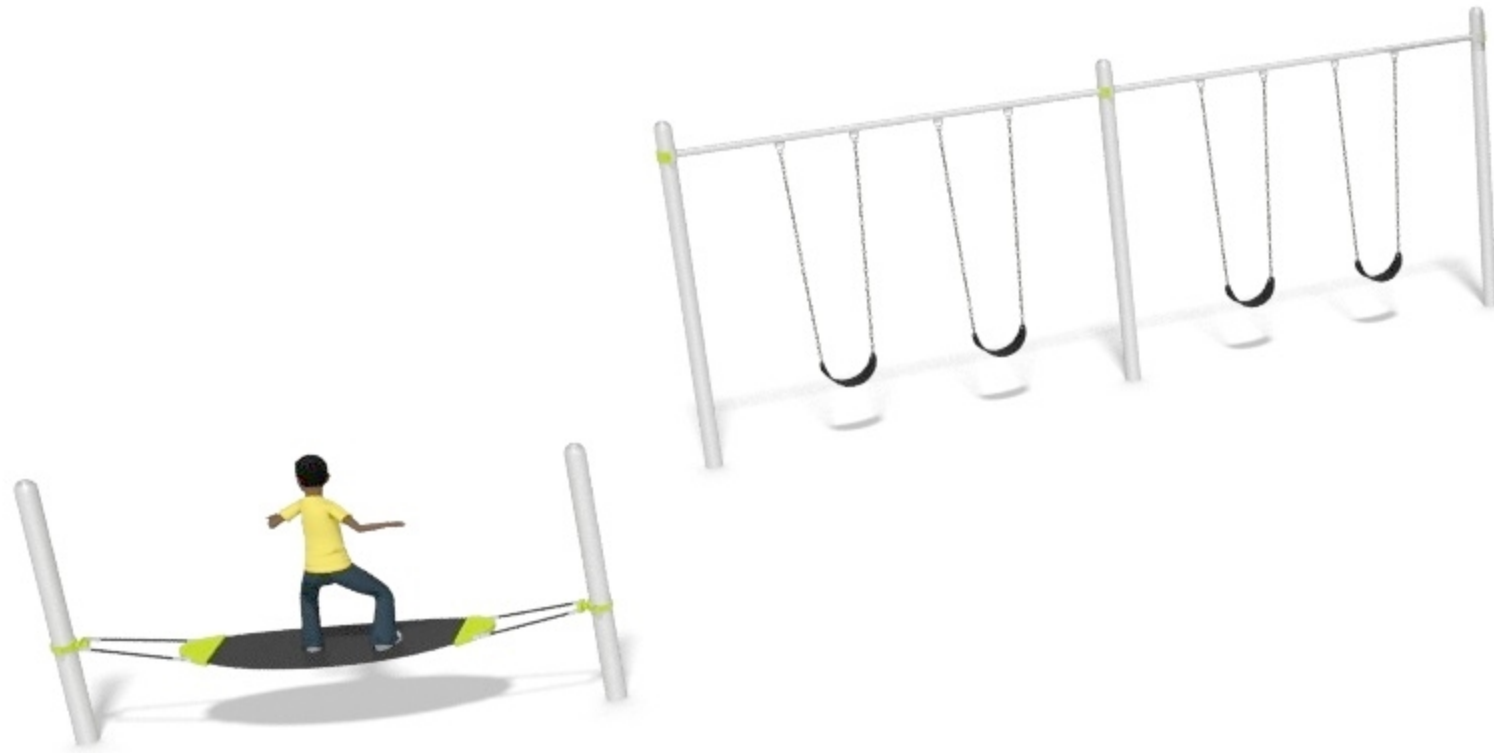

  
landscape  
structures®



**Better playgrounds.  
Better world.®**

[playlsi.com](http://playlsi.com)



Proudly presented by:  
Lance Shipman



 **Penchura** LLC